



---

# THAT LAKEHOUSE

---



VALLEY VIEWS

In a unique new build, “That Lakehouse” offers the extraordinary privilege of an elevated lakeside setting, capturing 360° views across the stunning Lake Yarrunga and its dramatic surrounding escarpments.

The home delivers leading-edge luxury with a sleek design that seamlessly integrates with the landscape, benefiting from its lake frontage.

Extensive glazing ensures the interiors are flooded with natural light and enjoy excellent cross ventilation for natural cooling.

The connection between indoor and outdoor spaces is paramount to the experience, with dual living areas flowing outside.

## **AWS** | PROJECT FEATURE

The Series 758 High Performance Sliding Door features recessed top and bottom rails, allowing a seamless transition between indoor and outdoor spaces. Two specific applications of these sliding doors span 6 metres in length, and when fully open, they allow fresh air from the Kangaroo Valley hills and Lake Yarrunga to fill the home.

Complementing these doors throughout the home is the Series 424 Double Glazed CentreGLAZE™ framing. The Series 424 is used in various applications, allowing fixed windows to sit next to awning windows, providing both views and fresh air in the same setting.

A standout feature is one application that spans 3 metres in length and nearly 2 metres in height, offering jaw-dropping, uninterrupted views of the valleys and lake beyond.

Featured Products: Series 758 High Performance Sliding Door, Series 424 Double Glazed CentreGLAZE™

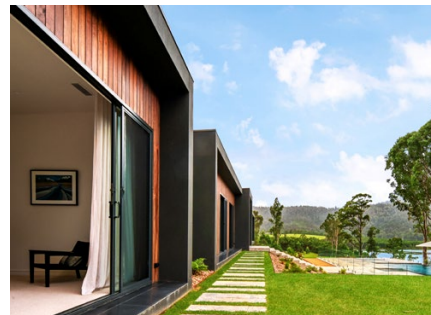

For the full gallery, visit: [awsaustralia.com.au/vantage](https://awsaustralia.com.au/vantage)

Builder: Brad Gibson Builder. Photographer: Chris Walters - [wm.studio](https://www.wm.studio)

### **Series 758 Residential High Performance Sliding Door**

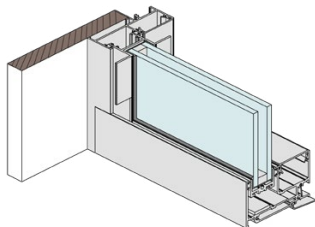

- × Series 758 High Performance Sliding Door is a residential door system designed to maximise sightlines by reducing the exposed aluminium frame.
  - × Option to have the rails and stiles concealed within the perimeter frame, providing a panoramic feel.
  - × Large sliding doors can be designed for high wind load areas and are available in extensive configurations with large spans.
  - × Designed exclusively to accept Vantage® Security Screens and BRIO pleated screens.
- Maximum Panel Height: 3000mm  
Maximum Panel Width: 2000mm  
Maximum Glass Thickness: ≤24mm  
SHGC Range: 0.22 - 0.7  
Uw Range: 2 - 3.7

**COASTLINE**  
ARCHITECTURAL  
WINDOWS

At Coastline Architectural Windows, we meet all your unique requirements from energy efficiency, durability and style. We focus on providing you every window designed and built to meet your specifications.

Phone: 02 4216 7535 | Web: [coastlineaw.com.au](https://coastlineaw.com.au)

2D & 3D CAD Files Available | Download from [specifyaws.com.au](https://specifyaws.com.au) to use in your projects.

